



Building better emergency care

Hampshire Health and Adult Social Care Committee, 28 June 2021

Working together To drive excellence in care for
our patients and communities

Background

40 years old

Our ED was not designed for the numbers of patients we now see and the condition of the environment is not as we would like

Rising demand

In 2019/20, we saw 16,000 more people than we did five years previously, and demand is projected to continue rising by 3% each year

Ways of working

Our ability to implement new models of care and best practice are limited by the constraints of the estate

Objectives

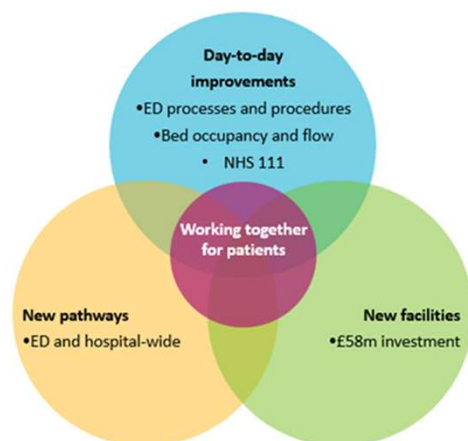

- 1 Develop and deliver a new clinical model to give the people of Portsmouth and South East Hampshire high quality emergency care
- 2 Reconfigure urgent and emergency care to maximise efficiency, making sure patients receive timely care in ED and throughout the hospital
- 3 Provide capacity to meet current and future demand, enabling PHU to meet national urgent care quality and access standards
- 4 Deliver modern facilities, meeting required standards and promoting positive patient experience and staff wellbeing

Roadmap

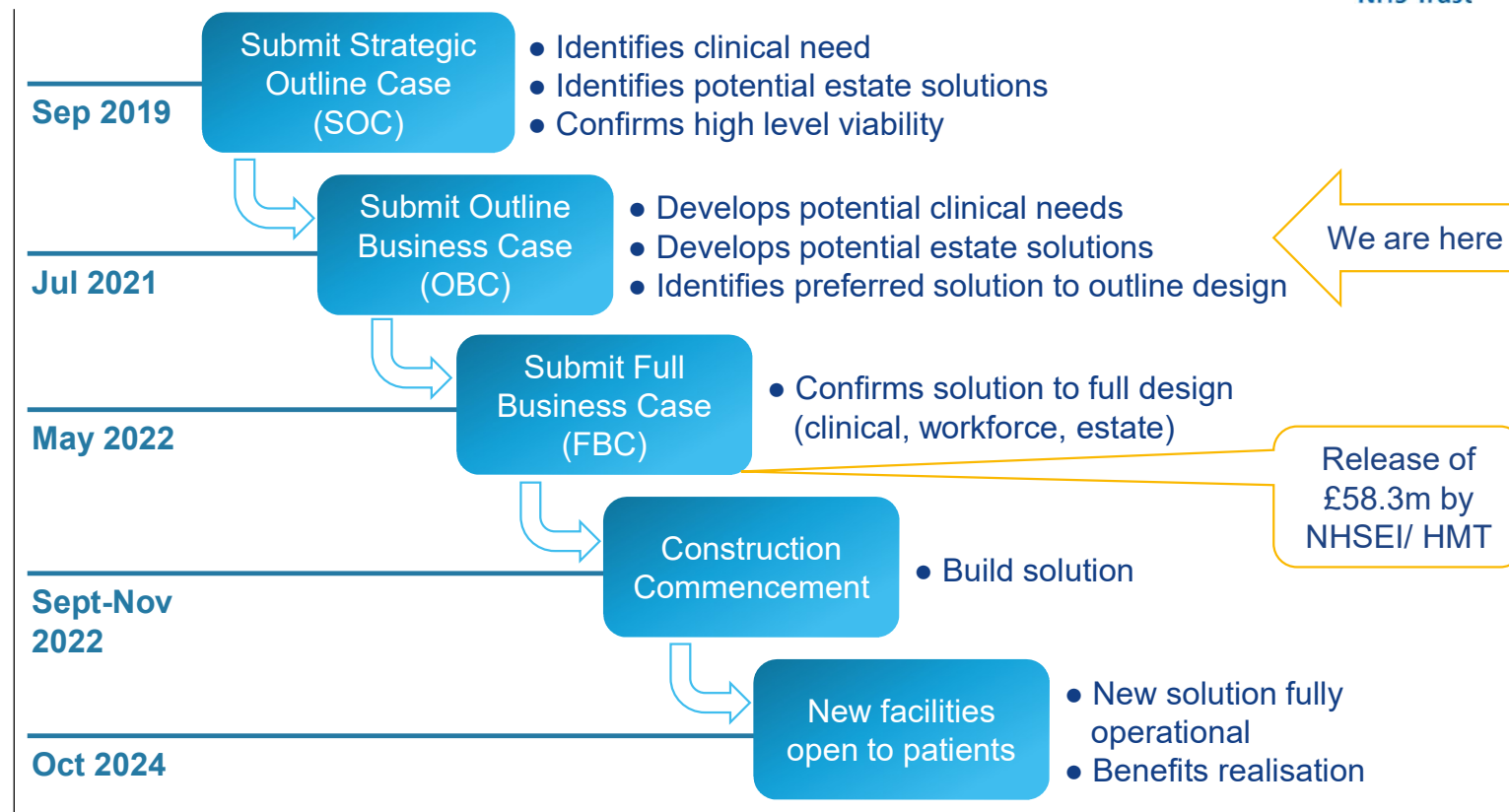

Location Options

1

Extension to the east of ED and refurb of existing ED footprint



2

Use of east staff car park for new build or part new build/ part refurb



3

Re-provide emergency floor facilities on north public car park



Preferred Location

New ED comprising three levels:

- Level A: staff car park (retaining 216 of the existing 522 spaces)
- Level B: clinical facilities - majors, urgent care, paediatrics, radiology and resus
- Level C: staff training, changing, offices, rest/relaxation and wellbeing space

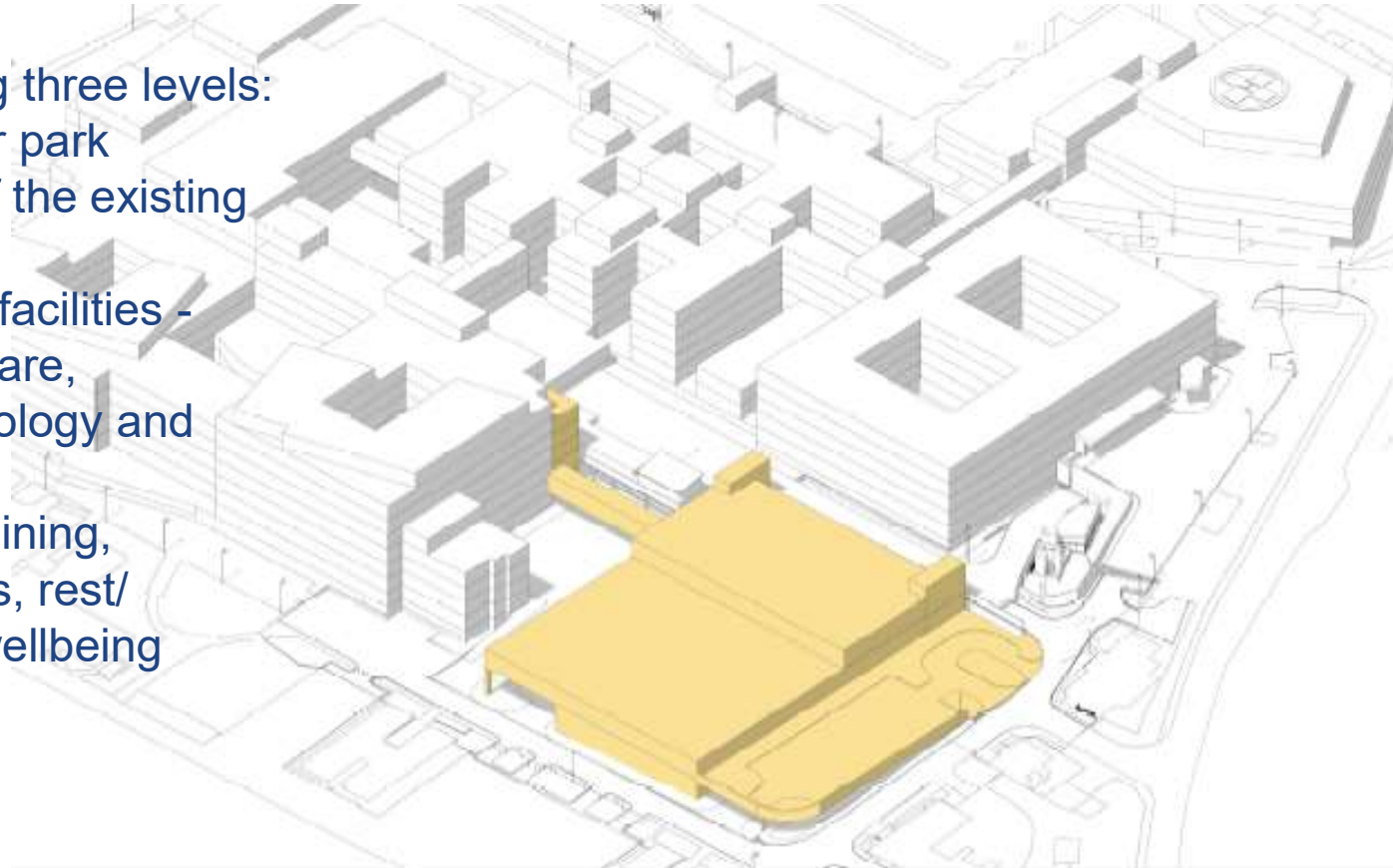

Level B

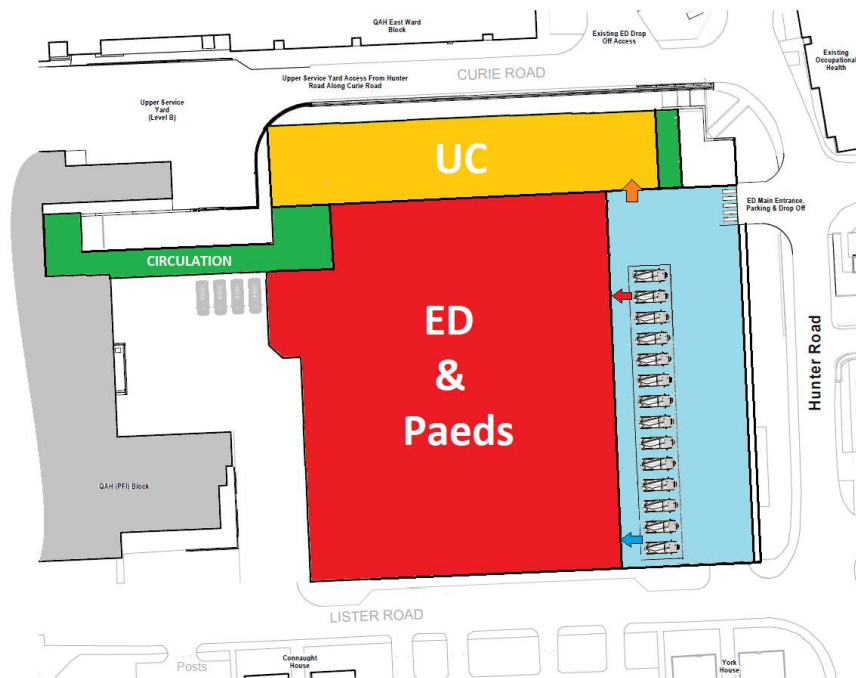

Level C

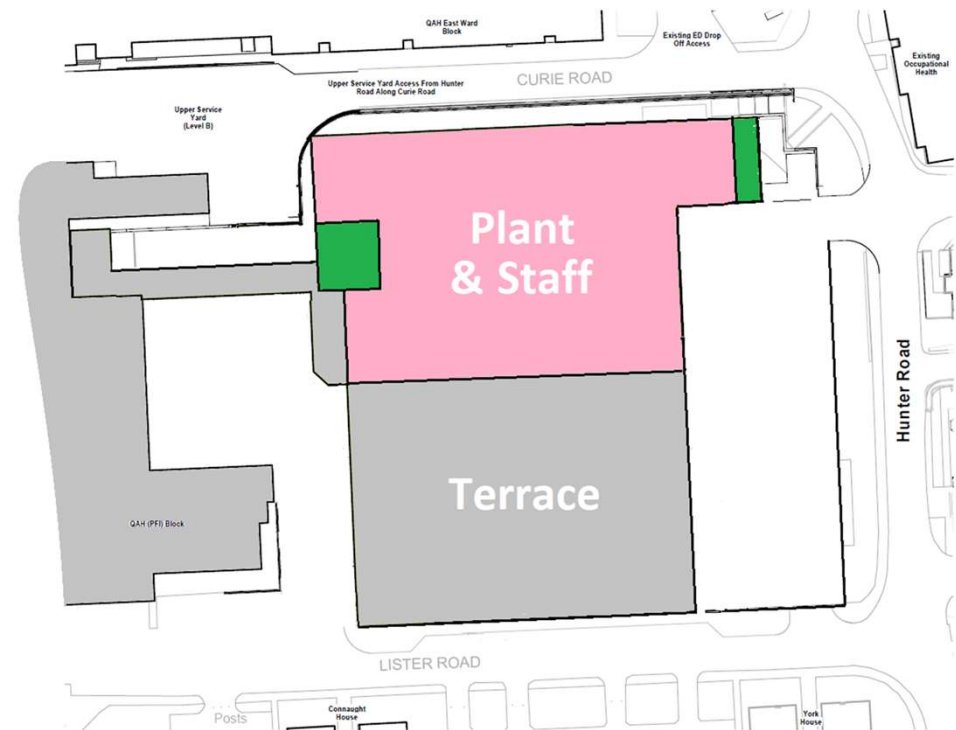

Level B

Sketch Design
1:500 Scale

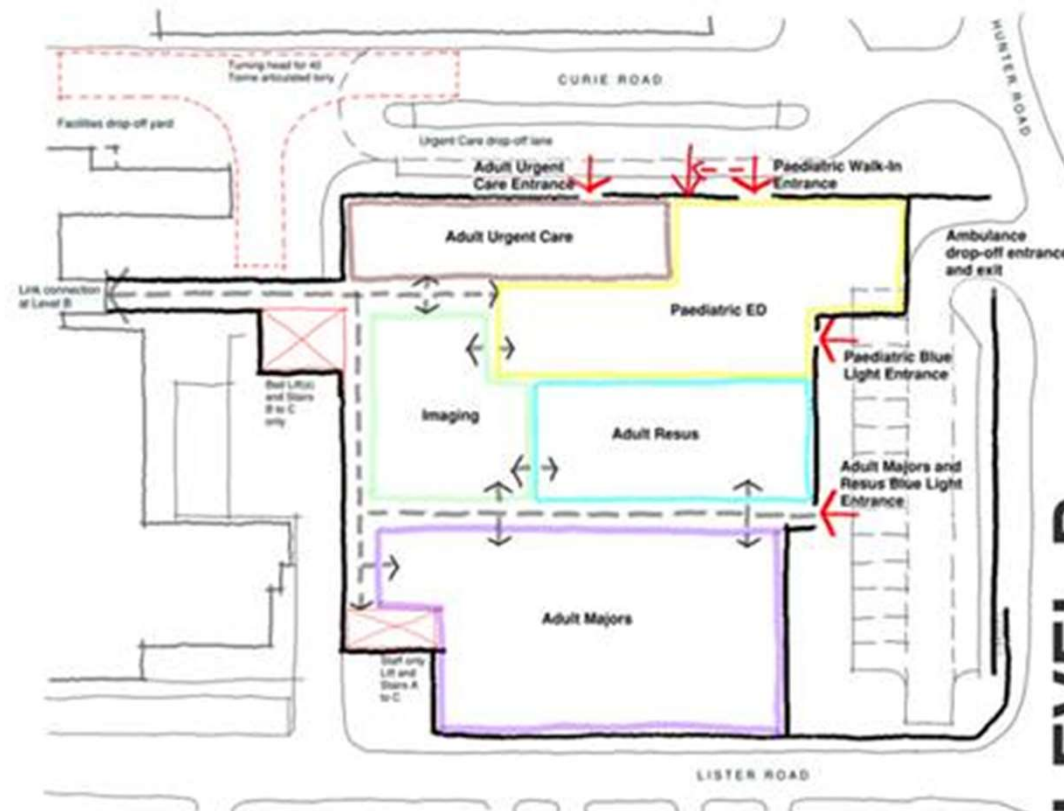

LEVEL B
ED Option D

Level B

Outline Design
1:200 Scale



Portsmouth Hospitals
University
NHS Trust

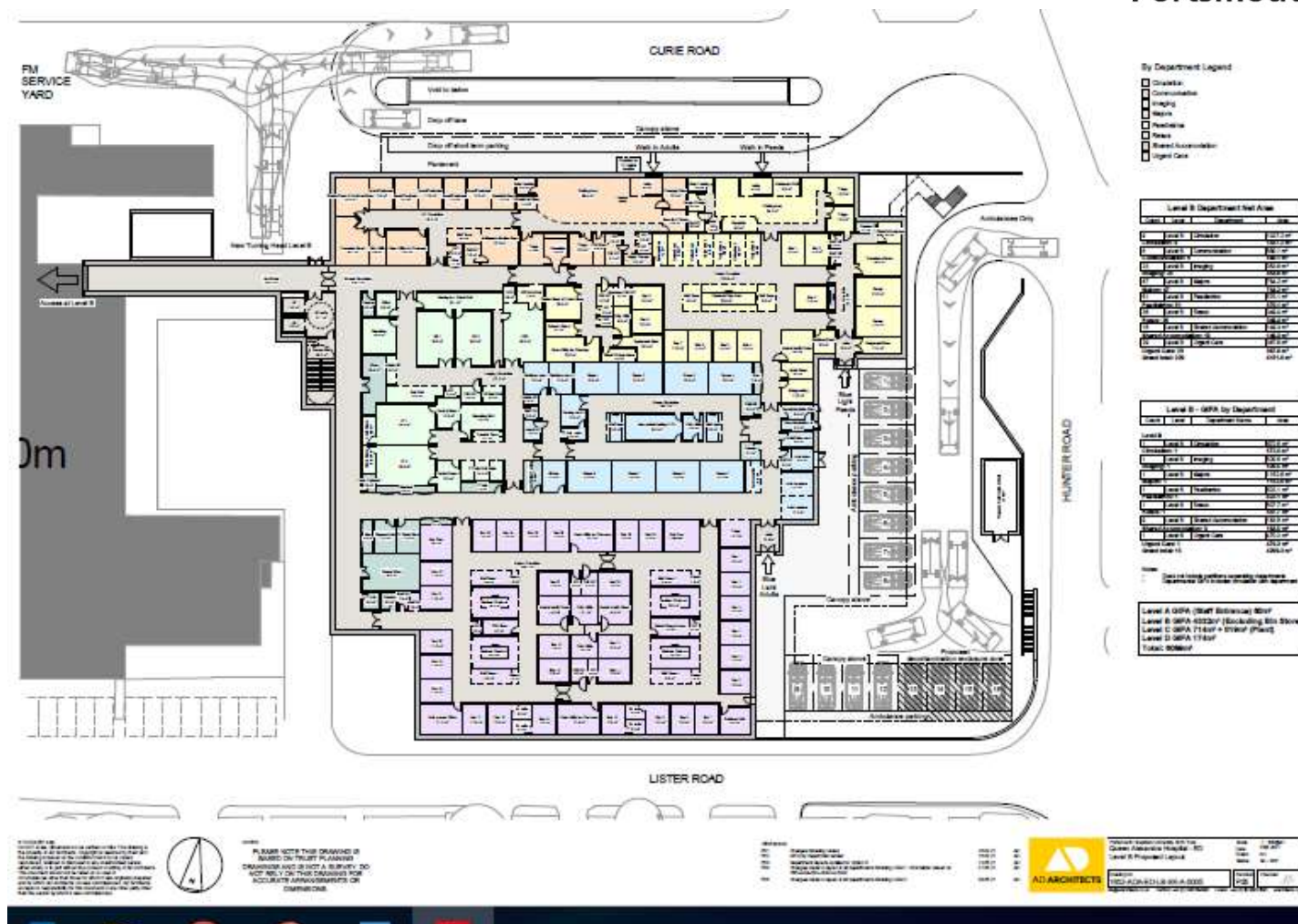

Outline Design 1:200 Scale



Level A

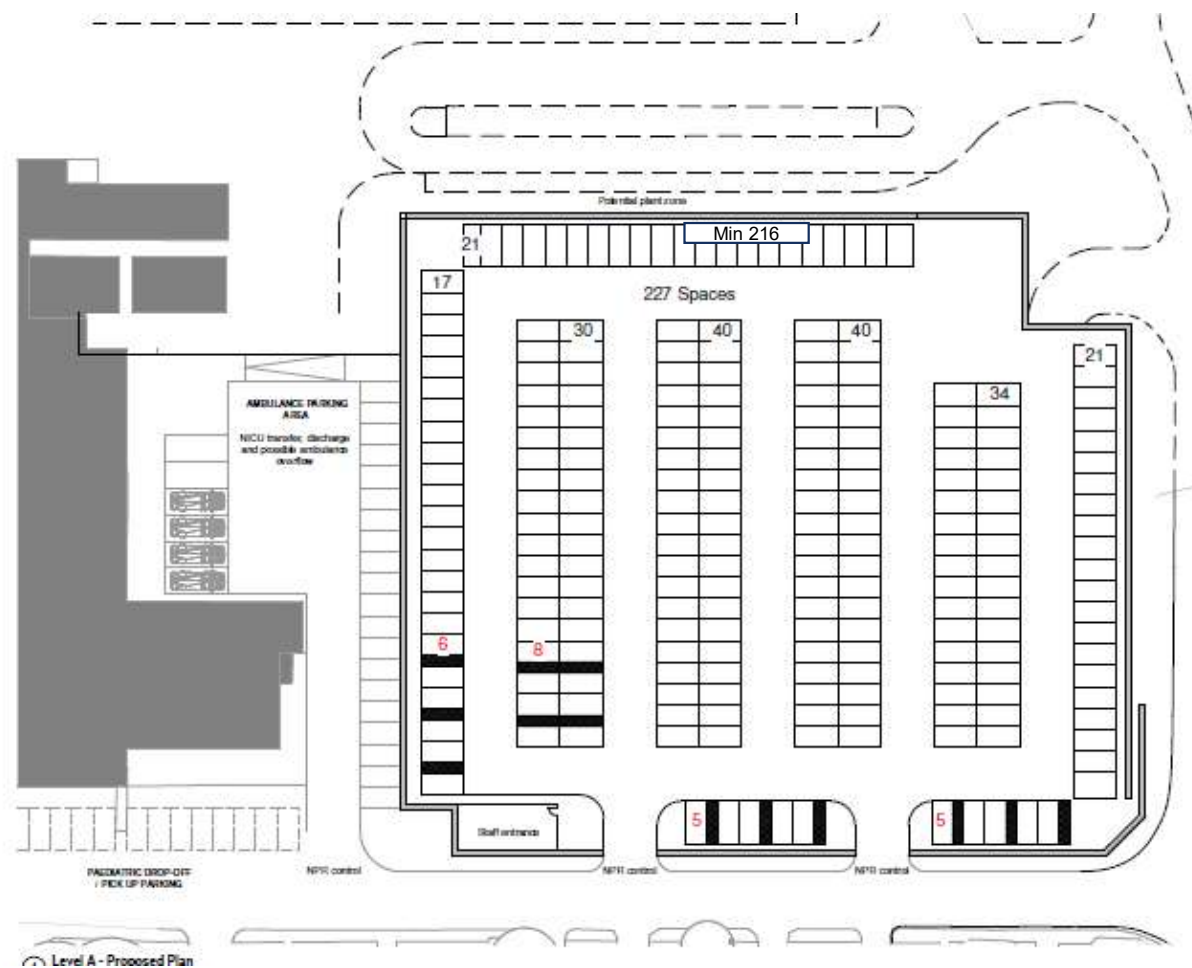

Traffic Flow

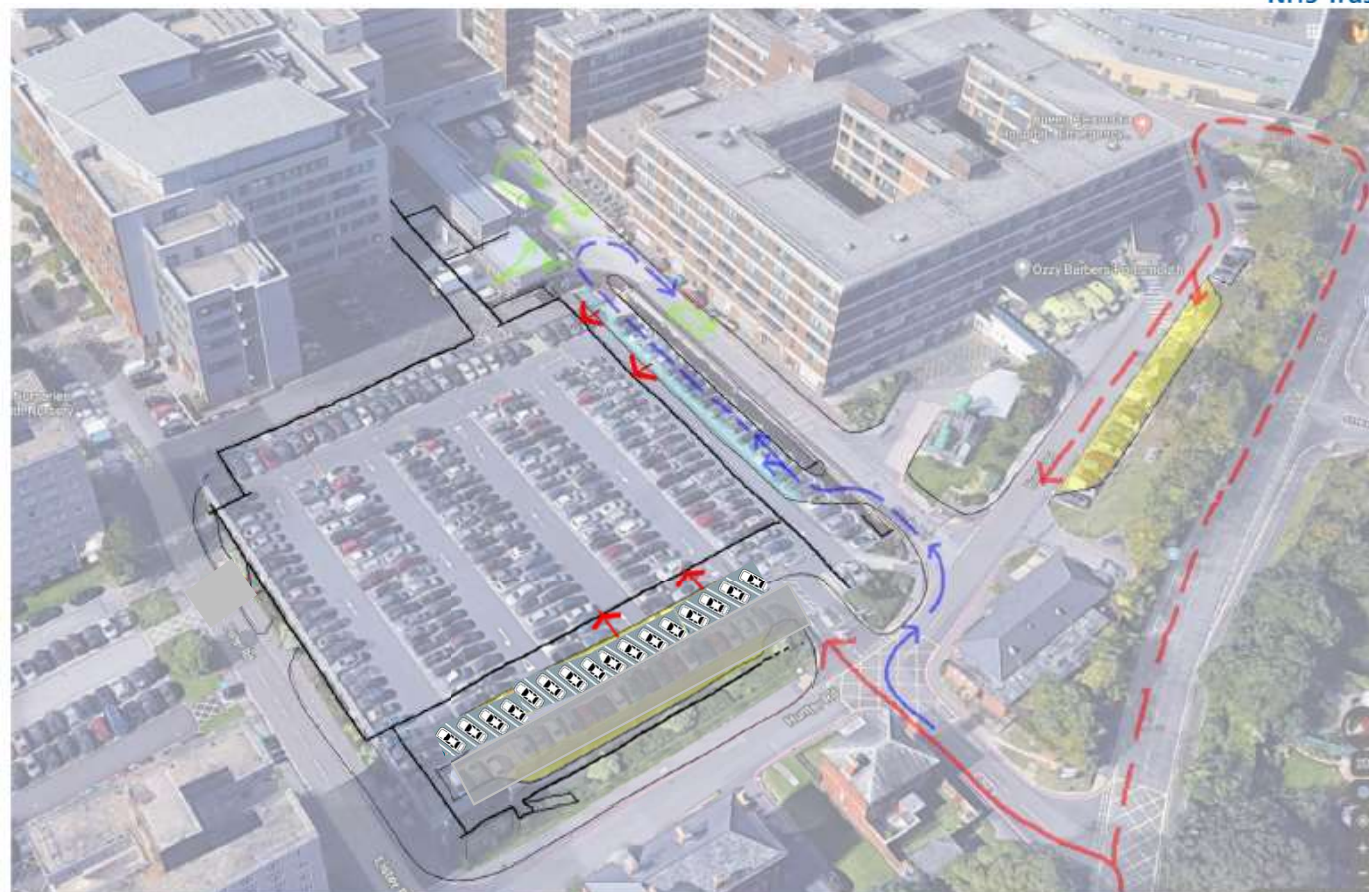

Ambulance Entrance



Walk in Entrance



Outline Design

The Trust submitted an outline planning application for the new ED to Portsmouth City Council in May 2021.

Clinicians have been closely involved in supporting the development of the 1:200 scale plans working with our project architects and partners throughout. The design includes:

- Adults and children will be treated in single rooms, improving privacy and dignity and enabling any patient with symptoms of Coronavirus or other respiratory conditions to be isolated quickly.
- Doubling resus capacity from four adult bays to eight will provide additional capacity for patients needing treatment for critical conditions.
- Two further paediatric resus bays will be provided for children.
- A new CT scanner, located within the ED, will mean patients requiring a specialist scan will be able to have one without leaving the department.
- The new department will also be energy-efficient, include easy-to-understand signage and wayfinding for visitors, and provide our staff team with dedicated rest areas to support their wellbeing.

Public and Patient Engagement

The new ED development will enhance the current provision of services, rather than changing their nature.

- Hampshire Health and Adult Social Care Committee, November 2020 (and June 2021)
- Portsmouth Overview and Scrutiny Panel, November 2020 (and September 2021)
- Healthwatch, March 2021
- Local MPs, May 2021
- The level of patient and public engagement has recently been limited due to Covid-19, however, wide ranging engagement activities are being restarted to inform the next stage of detailed design
- Join our mailing list and get involved: BBEC@porthosp.nhs.uk

Feedback so far



1	Environment	Cooler, better air conditioning, less noisy, more airy and friendly waiting room, less of a maze
2	Facilities	Wheelchair friendly, area for children in waiting room, better seating and space for visitors in treatment rooms
3	Experience	Info on arrival on what to expect and when, regular updates, space for dignity, bay not corridor for ambulance arrivals
4	Accessibility	More parking, disabled parking closer to ED, 30 min drop-off and collection point
5	Services	More triage teams, joined up IT with GPs and community, separate urgent care centre, patients with existing conditions admitted directly to specialities

Strategic Context:
 Unscheduled Care Priorities

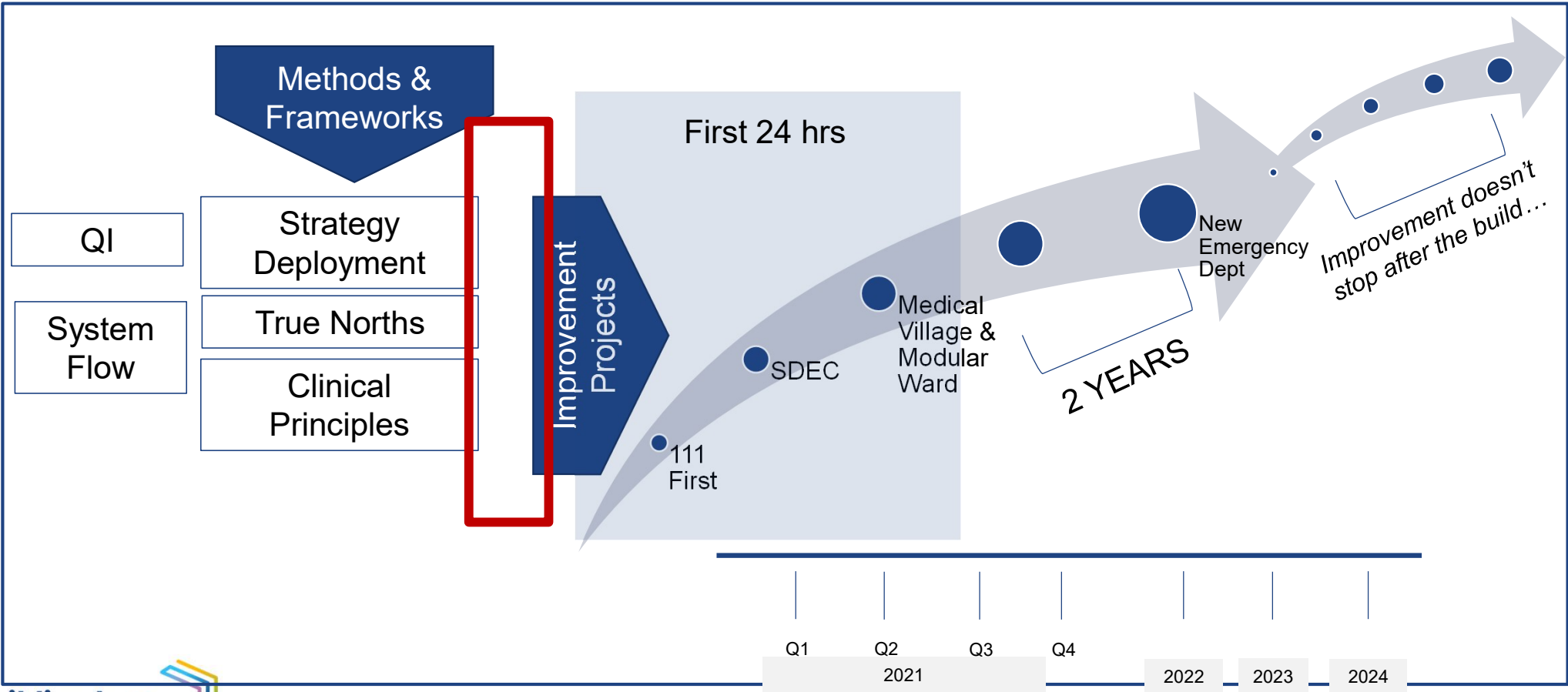

Questions

